

RB-35P

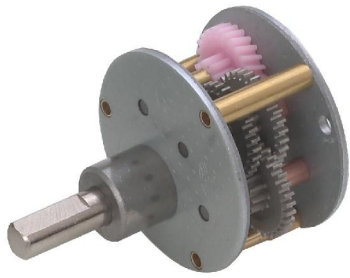

外殼材質 Housing material	金屬 metal	背隙 (無負荷時) Backlash, at no-load	≤ 2°
輸出軸承型式 Bearing at output		含油軸承 Sleeve bearings	
徑向負荷 Radial load (10mm from flange)			≤ 1 kgf
軸向負荷 Shaft axial load			≤ 0.7 kgf
主軸最大承受壓力 Shaft press fit force, max.			≤ 20 kgf
徑向間隙 Radial play of shaft			≤ 0.05 mm
軸向間隙 Thrust play of shaft			≤ 0.35 mm

外形尺寸 APPEARANCE SIZE

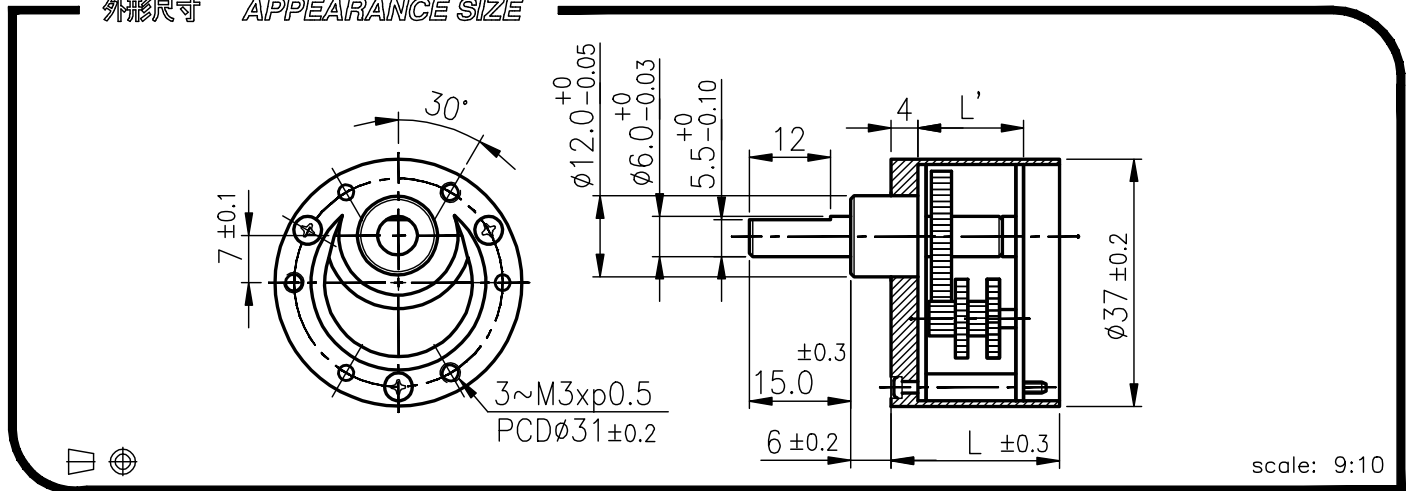

馬達齒輪型式 / PINION SPECIFICATIONS

模數 Module	0.5
齒數 No. of teeth	10
壓力角 Pressure angle	20°
螺旋角 Helix angle	18°(左, left)
孔徑 Hole diameter	φ1.98, φ2.28, φ2.48, φ2.98, φ3.16
減速比 Reduction ratio	全種通用 Practicable

馬達裝卸方法 / MOTOR INSTALLATION

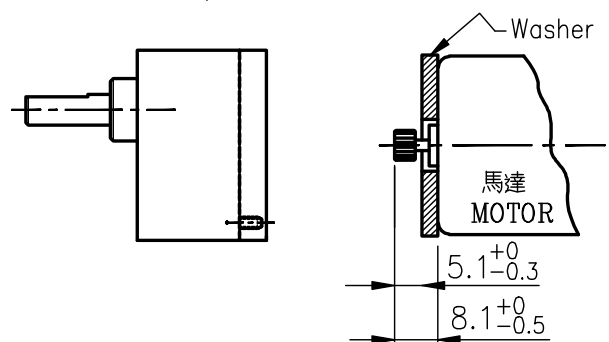

★ 使用相對溼度: 20%~85%RH ★ 使用溫度範圍: -10°C~+60°C
Operating relative humidity Operating temperature range

標準減速比型式 / GEARBOXES SPECIFICATIONS

減速比 Reduction ratio	定格容許扭力 Rated tolerance torque	瞬間容許扭力 Max momentary tolerance torque	效率 Efficiency	L'	L	重量 Weight (g)
1/18	1.0 kgf-cm Max.	3.0 kgf-cm	73%	15.0	22.0	91
1/30	1.2 kgf-cm Max.	3.6 kgf-cm	73%	15.0	22.0	91
1/50, 1/60, 1/75	2.0 kgf-cm Max.	6.0 kgf-cm	66%	17.5	24.5	98
1/90, 1/100	3.0 kgf-cm Max.	9.0 kgf-cm	66%	17.5	24.5	98
1/120, 1/150, 1/180, 1/200, 1/300	4.0 kgf-cm Max.	12.0 kgf-cm	59%	20.0	27.0	104
1/400, 1/450, 1/500, 1/600	4.0 kgf-cm Max.	12.0 kgf-cm	53%	22.5	29.5	110
1/900, 1/1000	4.0 kgf-cm Max.	12.0 kgf-cm	53%	22.5	29.5	110
1/1500, 1/3000	4.0 kgf-cm Max.	12.0 kgf-cm	48%	25.0	32.0	118