

RB-37S

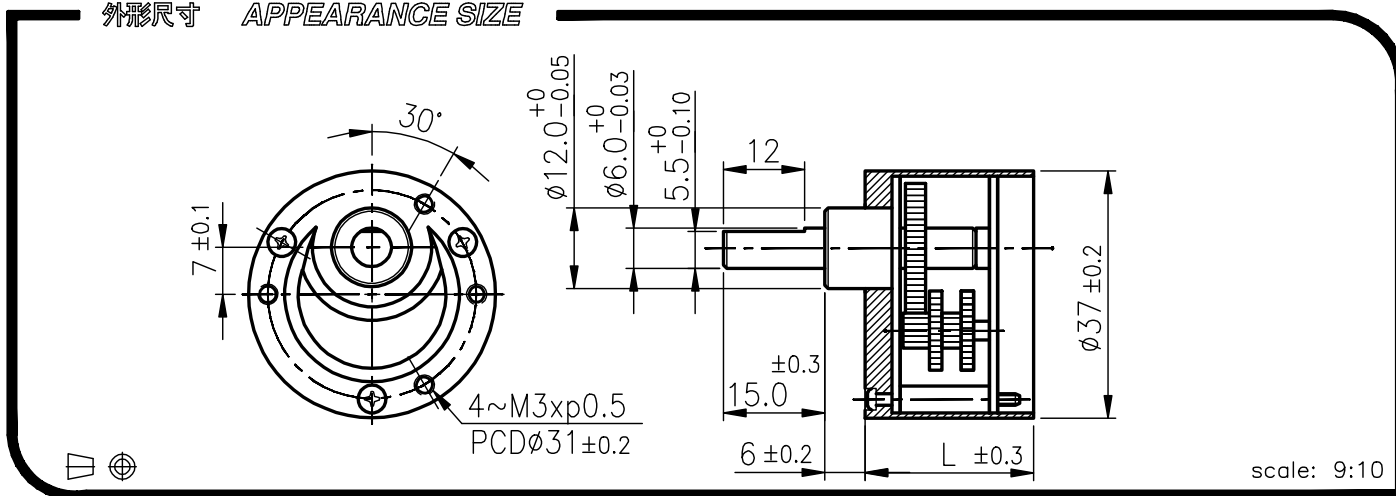

外殼材質 Housing material	塑膠 Plastic	背隙 (無負荷時) Backlash, at no-load	≤ 2°
輸出軸承型式 Bearing at output	含油軸承 Sleeve bearings		
徑向負荷 Radial load (10mm from flange)	≤ 1 kgf		
軸向負荷 Shaft axial load	≤ 0.7 kgf		
主軸最大承受壓入力 Shaft press fit force, max.	≤ 15 kgf		
徑向間隙 Radial play of shaft	≤ 0.05 mm		
軸向間隙 Thrust play of shaft	≤ 0.35 mm		

外形尺寸 APPEARANCE SIZE



馬達齒輪型式 / PINION SPECIFICATIONS

模數 Module	0.5
齒數 No. of teeth	10
壓力角 Pressure angle	20°
螺旋角 Helix angle	18°(左, left)
孔徑 Hole diameter	φ1.98, φ2.28, φ2.48, φ2.98, φ3.16
減速比 Reduction ratio	全種通用 Practicable

馬達裝卸方法 / MOTOR INSTALLATION

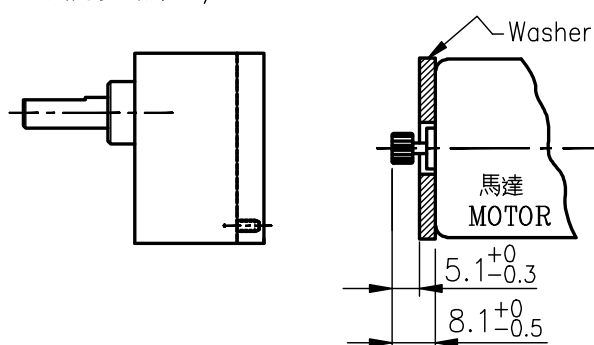

★ 使用相對溼度: 20%~85%RH ★ 使用溫度範圍: -10°C~+60°C
Operating relative humidity Operating temperature range

標準減速比型式 / GEARBOXES SPECIFICATIONS

減速比 Reduction ratio	定格容許扭力 Rated tolerance torque	瞬間容許扭力 Max momentary tolerance torque	效率 Efficiency	L	重量 Weight (g)
1/18	1.0 kgf-cm Max.	3.0 kgf-cm	73%	22.0	64
1/30	1.2 kgf-cm Max.	3.6 kgf-cm	73%	22.0	64
1/50, 1/60, 1/75	2.0 kgf-cm Max.	6.0 kgf-cm	66%	24.5	70
1/90, 1/100	3.0 kgf-cm Max.	9.0 kgf-cm	66%	24.5	70
1/120, 1/150, 1/180, 1/200, 1/300	4.0 kgf-cm Max.	12.0 kgf-cm	59%	27.0	73
1/400, 1/450, 1/500, 1/600	4.0 kgf-cm Max.	12.0 kgf-cm	53%	29.5	78
1/900, 1/1000	4.0 kgf-cm Max.	12.0 kgf-cm	53%	29.5	78
1/1500, 1/3000	4.0 kgf-cm Max.	12.0 kgf-cm	48%	32.0	82

RB-37SGM

11&12 TYPE



REDUCTION RATIO	L	REDUCTION RATIO	L
1/18~1/30	22.0	1/350~1/1000	29.5
1/36~1/100	24.5	1/1500~1/3000	32.0
1/120~1/300	27.0		

外形尺寸 APPEARANCE SIZE

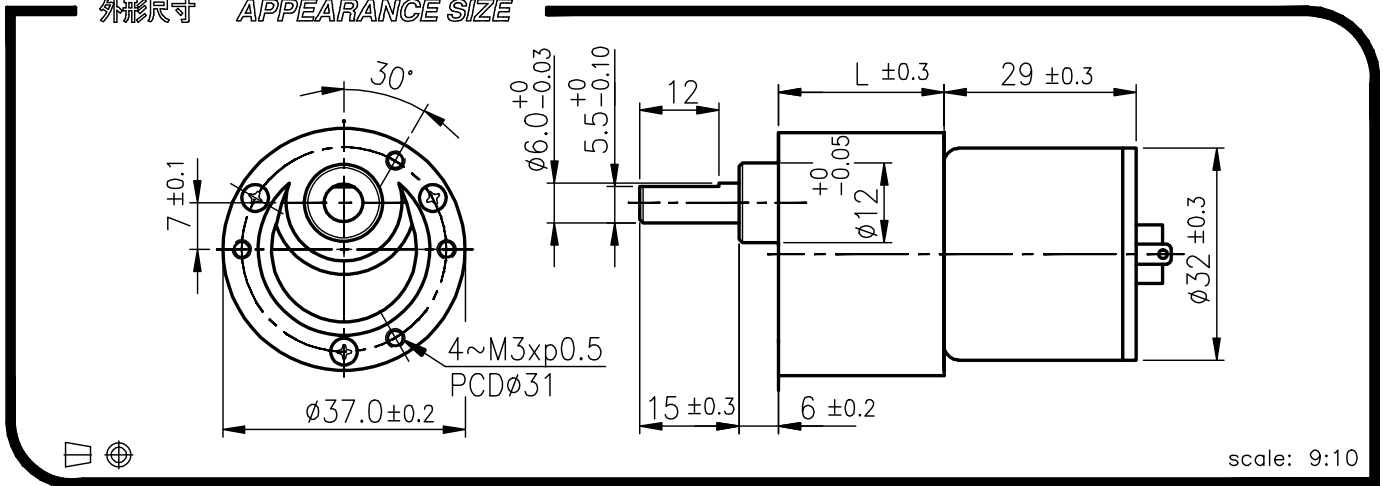

GEARED MOTOR TORQUE/SPEED

	減速比 Reduction ratio	REDUCTION RATIO																		
		1/18	1/30	1/50	1/60	1/75	1/90	1/100	1/120	1/150	1/180	1/200	1/250	1/300	1/500	1/600	1/750	1/1000	1/1500	1/3000
12V	定格扭力(Kg-cm) Rated torque	0.8	1.2	2.0	2.0	2.9	3.0	3.0	4.0	4.0	4.0	4.0	4.0	4.0	4.0	4.0	4.0	4.0	4.0	4.0
	定格回轉數(rpm) Rated speed	270	172	100	85	67	57.5	52	43	36	31	29	23	20.5	12	10	8	6.2	4.1	2.1
24V	定格扭力(Kg-cm) Rated torque	0.8	1.2	2.0	2.0	3.0	3.0	3.0	4.0	4.0	4.0	4.0	4.0	4.0	4.0	4.0	4.0	4.0	4.0	4.0
	定格回轉數(rpm) Rated speed	278	170	98	84	65	57	51	42	35	31	29	23	20	12	10	8	6.2	4.1	2.1

馬達單體型式 / MOTOR DATA

定格電壓 Rated volt (V)	定格扭力 Rated torque (g-cm)	定格回轉數 Rated speed (rpm)	定格電流 Rated current (mA)	無負荷回轉數 No load speed (rpm)	無負荷電流 No load current (mA)	定格出力 Rated output (W)	重量 Weight (g)
12	60	5100	≤ 470	6200	≤ 120	3.14	75
24	62	5000	≤ 210	6200	≤ 60	3.17	75

馬達單體特性圖 / MOTOR CHARACTERISTICS

